

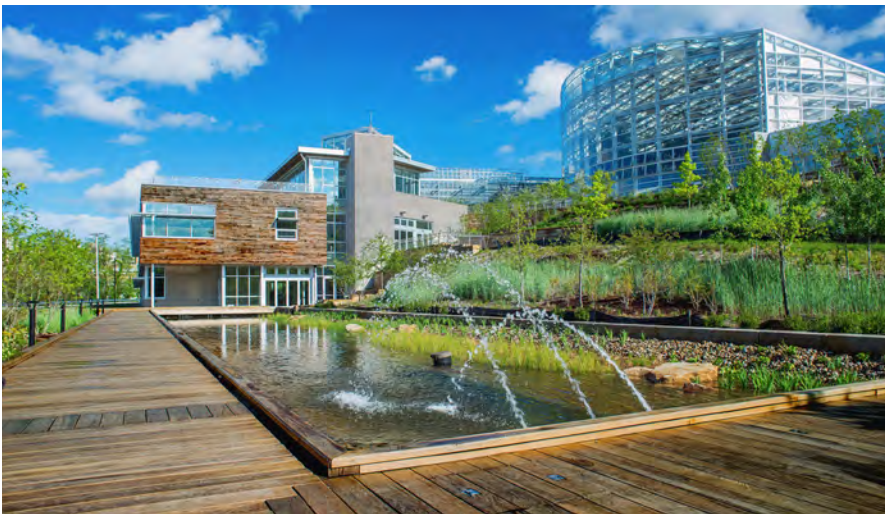

Chicago Navy Pier

<http://www.sustainablesites.org/chicago-navy-pier>



Phipps Center for Sustainable Landscapes

<http://www.sustainablesites.org/hipps-center-sustainable-landscapes>



East Bay Public Plaza

<http://www.sustainablesites.org/east-bay-public-plaza>

SITES[®]

lunch & learn w/ Jamie Statter

(USGBC Vice President of Strategic Accounts)

Monday, June 19
12pm - 1:30pm

Location:

Architects Hawaii Ltd
733 Bishop St #3100
Honolulu, HI 96813

Members of
ASLA/USGBC/APA/AIA/ULI: **\$15**

Non-members: **\$20**

[LUNCH INCLUDED]

**GBCI - 1 CEU
LACES - 1 CEU**

SITES Rating System is a sustainability-focused framework that ushers landscape architects, engineers and others toward practices that protect ecosystems and enhance the mosaic of benefits they continuously provide our communities, such as climate regulation, carbon storage and flood mitigation. SITES is the culmination of years of research and development by leading professionals in the fields of soil, water, vegetation, materials and human health.

<http://www.hawaii.asla.org/sites-lunchandlearn>

